

ONDULI ENCLAVE

DAMARALAND – PRIVATE RETREAT

ULTIMATE SAFARIS
LIFE ENRICHING JOURNEYS



LOCATION

GPS CO-ORDINATES

20°36'57.52"S 14°29'37.08"E

AIRSTRIP

Onduli Airstrip (20 minutes from camp)

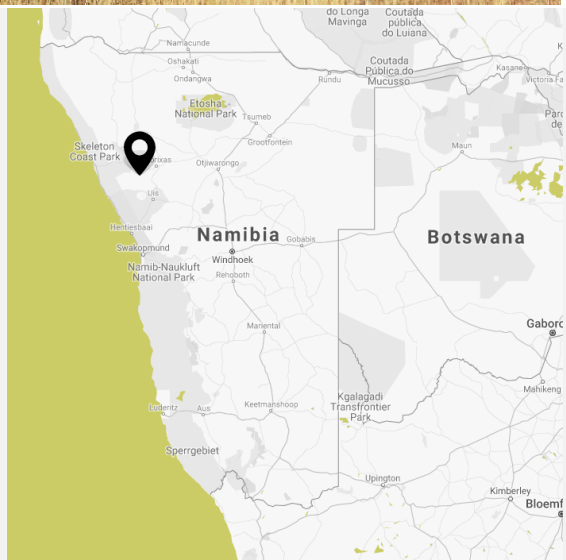

OVERVIEW

Onduli Enclave, the private villa addition to Onduli Ridge, will open officially on 1 November 2023. Named after the resident giraffe of the area, Onduli epitomizes mindful environmental integration and consideration, and the Onduli Enclave is a venue that allows guests the luxury of being at one with nature, whilst enjoying the ambience of Namibia's most exclusive and luxurious villa experience. Onduli Enclave is built high up against a south facing granite outcrop affording magnificent views of the Brandberg, Namibia's highest mountain to the south, the dispersed cathedral-like granite inselbergs to the southeast, and the

24-hour emergency: +264 81 141 2275 • Tel: +264 61 248137 • info@ultimatesafaris.na

Doros Crater to the west. The Enclave blends into its surroundings perfectly, maximizing the views of this most extraordinary landscape, and every space becomes a viewpoint whether from the bed, the desk, or the bathroom. Frameless glass stacking doors can be opened completely, blurring the lines between the indoors and nature, or closed when needed to take account of personal preference or local weather conditions. Three fully climate-controlled suites have super king-sized beds which can be rolled out onto your private deck for a night under a billion stars as required. Each suite also has a sleeper couch to accommodate a child, and there is an interleading lounge / children's room between two of the suites that is available for larger families. The villa exudes refinement and meticulous attention to detail meeting all requirements, from private sun decks with individual wood-fired hot tubs and shaded outside seating areas at each of the three suites, double inside and outside rain showers, private pool, pizza boma with a fire circle, and plenty of places to relax and laze, all connected by floating wooden decks. A private lounge, dining room and interactive open plan kitchen make up the common area, along with numerous outside areas for sitting and relaxing. World class meals prepared by a private chef and served by a private butler combine with the exceptional activities offered by a private guide to provide a genuinely unforgettable stay of exceptional quality, while everything blends effortlessly into the natural surroundings.

AT A GLANCE

- An exclusive use villa with three glass-fronted super king size suites
- Mini bars along with an ice cream and sorbet freezer, in-suite local craft gin bar, and an artisan coffee and tea station
- Fully climate-controlled suites
- Large bathrooms with double inside and outside showers
- Suites with private decks boasting wood-fired hot tubs, sun loungers and shaded sitting area
- Interleading lounge / children's room between two of the suites
- Minimum 4 / Maximum 10 (maximum 6 adults)
- Star beds
- Private swimming pool and sun deck
- Private guide, chef and butler
- Fully inclusive stays including all premium drinks as offered.
- Artisan tea and coffee
- Crafted pizza evenings
- Spacious private lounge, dining room, interactive open plan kitchen, campfire circle and pizza boma
- Open year-round
- Minimum 2 night stays (3 nights recommended)
- Children very welcome
- 100% solar powered
- 100% water reclamation
- Waterhole for wildlife viewing
- Use of the Swarovski binoculars provided in each suite
- WiFi throughout the venue

AREA

Onduli Enclave is located on a private concession in the Doro !Nawas Conservancy in the heart of Damaraland, and a mere 20 minutes away from the UNESCO World Heritage Site of Twyfelfontein. The landscape consists of rugged folded hills, plains and wooded river valleys in a largely semi-desert and sparse savannah. Boasting some of the most magnificent views of Namibia's highest mountain, the Brandberg, and the typical cathedral-like granite inselbergs of Damaraland, Onduli Enclave is within striking distance of other geological attractions such as the Burnt Mountain, Organ Pipes and Doros Crater. Named after the Doros Crater, Doro !Nawas means 'the place where rhinos roam' in the Khoekhoegowab language, and the area is home desert-adapted black rhino, elephant, giraffe and general plains game and predators such as cheetah, leopard, lion, spotted and brown hyena.

CAMP LAYOUT

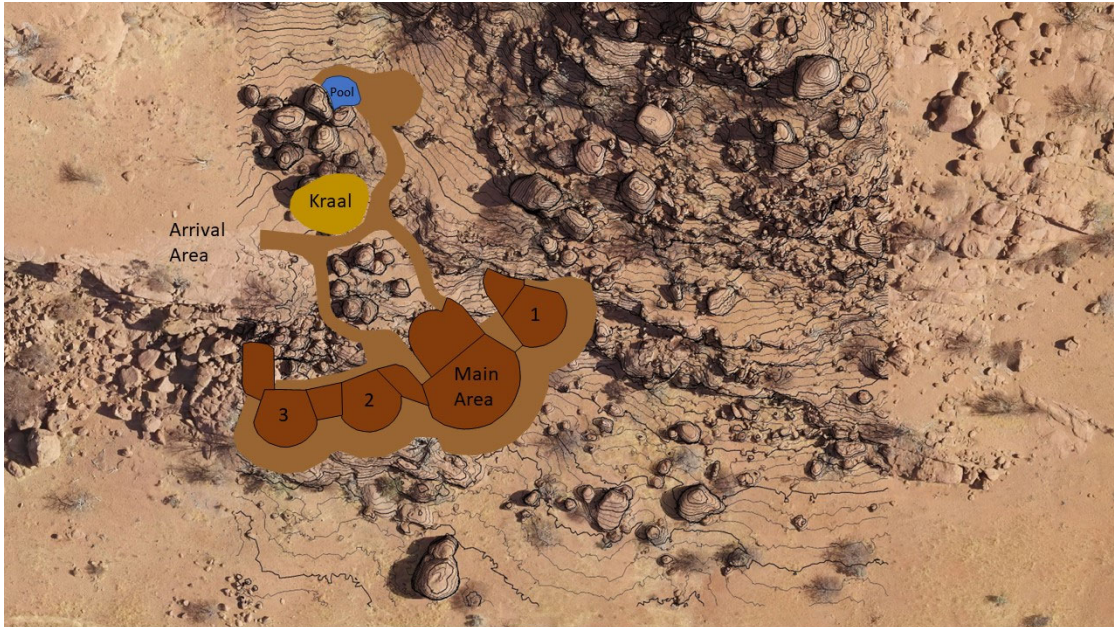

EXPERIENCES



ELEPHANT TRACKING



**BLACK RHINO TRACKING
(EXTENDED STAYS ONLY)**

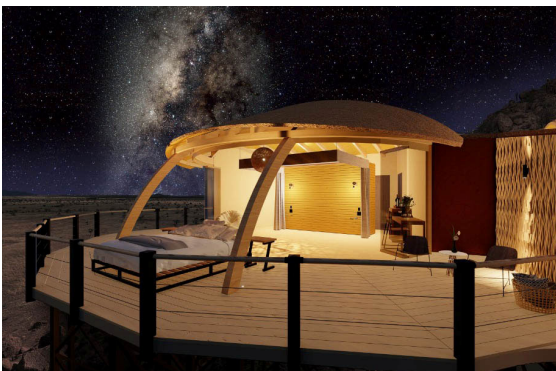

STAR BEDS



SOLAR E-BIKING

24-hour emergency: **+264 81 141 2275** • Tel: **+264 61 248137** • info@ultimatesafaris.na



ROCK ART



NATURE DRIVES



NATURE WALKS



TRAIL TREATS

IMPACT



GRANIETKOP CAMPSITE



DORO !NAWAS CONSERVANCY



SAVE THE RHINO TRUST (SRT)



WILDLIFE CREDITS

24-hour emergency: **+264 81 141 2275** • Tel: **+264 61 248137** • info@ultimatesafaris.na



GIRAFFE CONSERVATION FOUNDATION



PACK FOR CONSERVATION

GALLERY

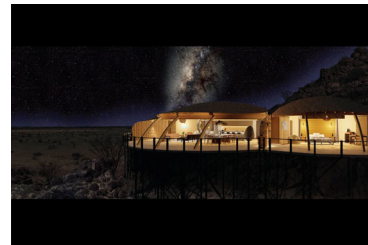

24-hour emergency: **+264 81 141 2275** • Tel: **+264 61 248137** • info@ultimatesafaris.na